

SV673

High Purity Precision Dispensing Pump, Solenoid Operated, Piston Driven



Valcor Engineering Corporation



DESCRIPTION

The SV673 Series Air-Operated High Purity Precision Dispensing Pumps are compact piston operated, variable displacement metering pumps designed to dispense precise volumes of liquid. The SV673 has no metallic parts in the flow path, only polypropylene, glass and elastomers are in contact with the media. The dispense volume is set using the external adjustment. Cycling the pump using a 3-way general purpose solenoid valve creates a single, discrete dispense volume. Multiple cycles create a total dispensed volume. The pump is pulsed continuously to create a metered flow. The simple design ensures accurate dispensing over an exceptionally long service life without the need for maintenance.

APPLICATION

The SV673 series are used to dispense any high purity liquid compatible with polypropylene, glass and elastomer seals. Examples include: analytical and medical instruments and equipment, highly acidic or alkaline liquid dispensers, pH adjustment systems, liquid chromatography reagents and diluents, and potable and waste water treatment chemicals.

FEATURES

- No metallic parts in the fluid path
- Dispense volume range of 100 μ L to 1500 μ L per stroke (AC version)
- Flow Rate: 90 mL/Min of water or similar viscosity liquids
- Self-priming with up to 60" suction head
- Self-lubricating
- Polypropylene construction with glass sleeve and elastomeric seals
- Economic alternative to syringe and peristaltic pumps
- Fully customizable for your application

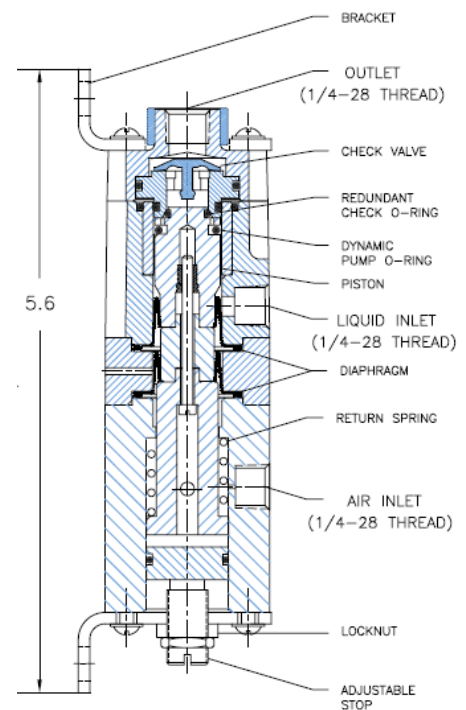
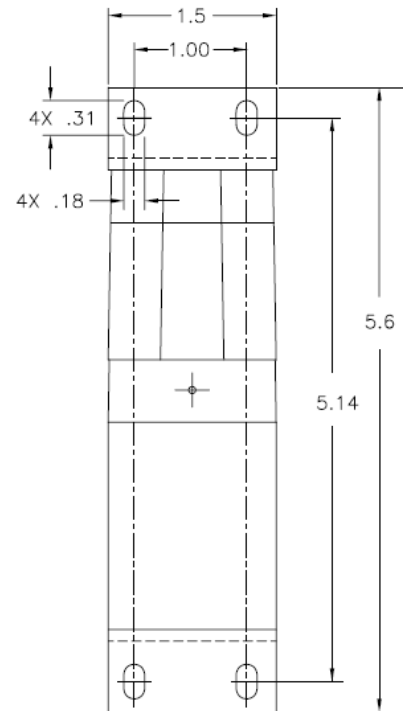

Custom designs are our specialty. Contact us today to see how we can help on your next project.

Valcor Engineering Corporation
2 Lawrence Road | Springfield, NJ 07081
(973) 467-8400 | scientific@valcor.com
www.valcor.com

SV673

High Purity Precision Dispensing Pump, Solenoid Operated, Piston Driven



Valcor Engineering Corporation

Valve Parts in Contact with Fluid

Wetted Materials	Polypropylene, Glass, EDPM with Santoprene
------------------	--

Electrical

Standard Voltages	115/60 Hz, 24/DC or 12/DC
Standard Coil Housing	General purpose with pigtail leads

Specifications

Tube Connection	1/4 - 28 Thread
	Min. inlet tube 1/8" I.D.
Actuation Pressure	30 to 60 PSI air
Output per Stroke	100 to 1500 μ l (AC)
Max. Dispense Rate	90 ml/min
Max. Priming Height	60" of H ₂ O
Minimum On-Time	250 milliseconds
Repeatability	\pm 2%
Special Requirements	Consult Factory
