

SV520-55-C500

Diffuser



Valcor Engineering Corporation



DESCRIPTION

Valcor's SV520-55-C500 Diffuser is a multiple hole single-body coupling designed to produce a pressure drop in a high pressure steam or water system. The diffuser incorporates a series of precision holes the size and location of which are calculated to produce maximum noise reduction and energy dissipation. The diffuser can be used singly, or in multiple stages to produce the required pressure drop. Machined from stainless steel bar stock, the SV520-55-C500 Diffuser is robust, and maintenance free. With no moving parts to break or wear, it will last for the life of the system in which it's installed.

APPLICATION

The SV520-55-C500 Diffuser is designed to mitigate the damage caused by the rapid reduction of pressure in a flowing hot condensate or boiler feed water line. Typical uses include pressure reduction for boiler feedwater recirculation pumps and warm up systems, boiler blow downs and steam traps. The SV520-55-C500 Diffuser is also employed to reduce the noise generated by high pressure steam and air venting systems.

FEATURES

- Compact size and low weight save space and stress on process piping
- Simplifies process control systems by eliminating multiple components
- ASME-SA479, Type 316 stainless steel bar stock body
- ANSI Class 6000 pressure rating
- Socket weld porting for 3/4" to 4" piping
- Hole size, quantity and placement calculated per customer requirements
- Virtually maintenance free
- Mountable in any orientation

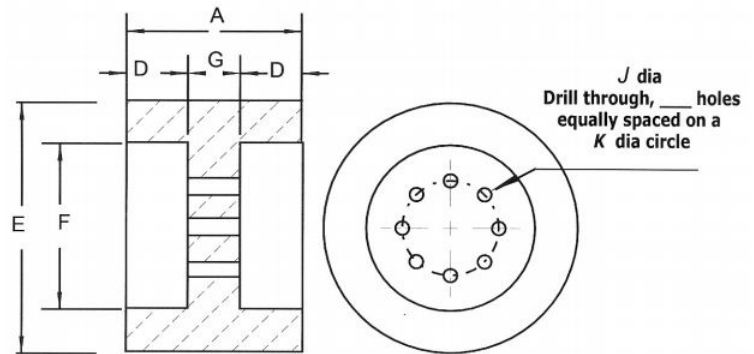

SPECIFICATIONS
Socket Weld
ASME-SA-479, Type 316 SS
Rating ANSI Class 6000

Model C500 Dimensions

Size	A	E	F
1	1.75	2.25	1.330
1-1/2	2	3	1.915
2	2.5	3.625	2.406
4	3	6.25	4.545

For sizes larger than 4" or for plate-type diffusers see the model [C600](#) Diffusers

Custom designs are our specialty. Contact us today to see how we can help on your next project.

Valcor Engineering Corporation
2 Lawrence Road | Springfield, NJ 07081
(973) 467-8400 | scientific@valcor.com
www.valcor.com