

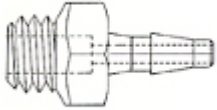

INSTRUMENT VALVE FITTINGS

Standard Barb Fittings



These standard barb fittings are molded with mold tooling designed to eliminate parting lines on the critical sealing surface of the barbs. The product does not contain regrind and is made from certified materials. All Standard Fittings are made from Polypropylene.

| Part Number | Configuration | | Material |
|-------------|---------------|------|---------------|
| | Port | Barb | |
| SVFITM081 | 10-32 | 3/32 | Polypropylene |
| SVFITM082 | 10-32 | 1/8 | Polypropylene |
| SVFITM083 | 1/4-28 | 1/16 | Polypropylene |
| SVFITM084 | 1/4-28 | 3/32 | Polypropylene |
| SVFITM085 | 1/4-28 | 1/8 | Polypropylene |
| SVFITM086 | 1/4-28 | 3/16 | Polypropylene |
| SVFITM087 | 1/8 NPT | 1/16 | Polypropylene |
| SVFITM088 | 1/8 NPT | 3/32 | Polypropylene |
| SVFITM089 | 1/8 NPT | 1/8 | Polypropylene |
| SVFITM090 | 1/8 NPT | 3/16 | Polypropylene |
| SVFITM091 | 1/8 NPT | 1/4 | Polypropylene |

Barb Fittings—Zero Dead Volume

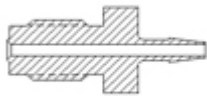

These Zero Dead Volume fittings were designed to eliminate unwanted dead volume created when using standard fittings. Where dead volume is a concern, these fittings are a must. Most Zero Dead Volume Fittings are made from Kel-F®.

| Part Number | Configuration | | Material |
|-------------|---------------|------|----------|
| | Port | Barb | |
| SVFITM328 | 10-32 | 1/16 | Kel-F |
| SVFITM329 | 10-32 | 3/32 | Kel-F |
| SVFITM330 | 10-32 | 1/8 | Kel-F |
| SVFITM331 | 1/4-28 | 1/16 | Kel-F |
| SVFITM332 | 1/4-28 | 3/32 | Kel-F |
| SVFITM333 | 1/4-28 | 1/8 | Kel-F |
| SVFITM211 | 1/4-28 | 5/32 | Kel-F |
| SVFITM334 | 1/4-28 | 3/16 | Kel-F |